



S-377
BARREL HOOKS

- Forged Carbon Steel - Quenched and Tempered.
- Meets the performance requirements of Federal Specification RR-C-271F, Type V, Class 6, except for those provisions required of the contractor.



S - 377 Barrel Hooks

Working Load Limit Per Pair (t)*	S-377 Stock No. Per Pair	Weight Each Per Pair (kg)	Dimensions (mm)			
			I.D. of Eye	O.D. of Eye	Overall Length	Width of Lip
1	1028248	1.61	39.6	71.4	127	73.2



S-3316
REPLACEMENT HOOK

- Easily attaches to any chain and electric hoist with welded link load chain, roller chain or wire rope with suitable end fitting.
- Swivel jaw is forged.
- Suitable for infrequent, non-continuous rotation under load.
- Use in corrosive environment requires shank and nut inspection in accordance with ASME B30.10-1.10.4(b)(5)(c)2009.

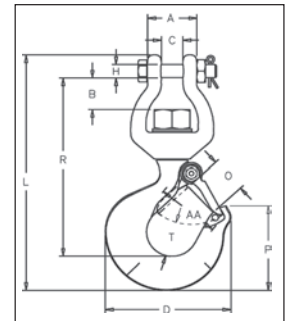

SEE APPLICATION AND WARNING INFORMATION
 On Pages 142 - 143
 Para Español: www.thecrosbygroup.com

S-3316 Replacement Hook

Working Load Limit (t)*	Frame Code	S-3316 Stock No	Weight Each (kg)	Dimensions (mm)										Replacement Latch Kit Stock No.
				A	B	C	D	H	L	O	P	R	T	
.45	F	1023029	.57	33.3	19.3	14.2	81.0	9.65	155	24.6	57.0	117	20.6	1096374
.91	H	1023047	1.18	39.6	25.4	17.5	104	11.2	195	28.4	72.0	148	30.2	1096468

*Ultimate Load is 5 times the Working Load Limit.



A-378
SORTING HOOK

- Forged Alloy Steel - Quenched and Tempered.
- Deep straight throat permits efficient handling of flat plates or large cylindrical shapes.



A-378
SORTING HOOK

A-378 Sorting Hook

Working Load Limit at tip of Hook (t)*	Working Load Limit at bottom of Hook (t)*	A-378 Stock No	Style	Weight Each (kg)	Dimensions (mm)			
					I.D. of Eye	Overall Length	Opening at top of Hook	Radius at bottom of Hook
1.8	6.8	1028024	No Handle	2.91	35.0	246	71.4	15.9
1.8	6.8	1028033	With Handle	2.91	35.0	246	71.4	15.9

*Ultimate Load is 4 times the Working Load Limit.