

U-rørbøjle DVS 31005

Pipe clamp U-shaped DVS 31005



■ ■ U-rørbøjle DVS 31005, sorte, varmgalvaniseret, syrefast AISI 316. Rundjern med rullet gevind.

■ ■ U-shaped pipe clamp DVS 31005, black, hot galvanized, acid resistant AISI 316. Round bars with rolled thread.

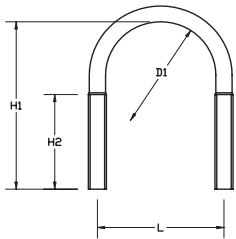

| D ₁ mm | For rør med udvendig dia. på: / For pipes with external dia. of: mm | Tommer / Inches | Hul for bøjle / Hole for clamp mm | Tol. % | H ₁ mm | H ₂ mm | L mm | D ₂ mm |
|-------------------|--|--------------------|--------------------------------------|--------|-------------------|-------------------|------|-------------------|
| 23 | 20/21,3/22 | ½" | 9 | +1/0 | 50 | 35 | 31 | M8 |
| 28 | 25/26,9 | ¾" | 9 | +1/0 | 55 | 35 | 36 | M8 |
| 32 | 28/30 | | 9 | +1/0 | 60 | 40 | 40 | M8 |
| 36 | 33,7/35 | 1" | 9 | +1/0 | 65 | 40 | 44 | M8 |
| 40 | 38 | | 11 | +1/0 | 70 | 40 | 50 | M10 |
| 44 | 42/42,4 | 1 ¼" | 11 | +1/0 | 75 | 40 | 54 | M10 |
| 46 | 44,5 | | 11 | +1/0 | 75 | 40 | 56 | M10 |
| 50 | 48,3 | 1 ½" | 11 | +1/0 | 80 | 50 | 60 | M10 |
| 59 | 54/57 | | 14 | +1/0 | 90 | 55 | 71 | M12 |
| 62 | 60,3 | 2" | 14 | +1/0 | 95 | 60 | 74 | M12 |
| 78 | 76,1 | 2 ½" | 14 | +2/0 | 110 | 60 | 90 | M12 |
| 91 | 88,9 | 3" | 14 | +2/0 | 125 | 75 | 103 | M12 |
| 110 | 108 | | 18 | +2/0 | 150 | 75 | 126 | M16 |
| 117 | 114,3 | 4" | 18 | +2/0 | 155 | 75 | 133 | M16 |
| 136 | 133 | | 18 | +2/0 | 170 | 75 | 152 | M16 |
| 146 | 139,7 | 5" | 18 | +2/0 | 175 | 75 | 162 | M16 |
| 162 | 159 | | 18 | +2/0 | 190 | 75 | 178 | M16 |
| 174 | 168,3 | 6" | 18 | +2/0 | 215 | 75 | 190 | M16 |
| 198 | 193,7 | | 18 | +2/0 | 240 | 75 | 214 | M16 |
| 225 | 219 | 8" | 22 | +3/0 | 270 | 90 | 245 | M20 |
| 270 | 267 | | 22 | +3/0 | 310 | 90 | 290 | M20 |
| 278 | 273 | 10" | 22 | +3/0 | 325 | 90 | 298 | M20 |
| 330 | 323,9 | 12" | 26 | +3/0 | 385 | 100 | 354 | M24 |
| 360 | 355,6 | 14" | 26 | +3/0 | 415 | 100 | 384 | M24 |
| 371 | 368 | | 26 | +3/0 | 425 | 100 | 395 | M24 |
| 411 | 406,4 | | 26 | +3/0 | 465 | 100 | 435 | M24 |
| 422 | 419 | 16" | 33 | +3/0 | 475 | 110 | 452 | M30 |
| 462 | 457,2 | 18" | 33 | +3/0 | 525 | 110 | 492 | M30 |
| 515 | 508 | 20" | 33 | +3/0 | 580 | 110 | 545 | M30 |
| 618 | 610 | | 33 | +3/0 | 690 | 110 | 643 | M30 |
| 719 | 711 | | 39 | +3/0 | 795 | 150 | 755 | M36 |
| 822 | 813 | | 39 | +3/0 | 900 | 150 | 858 | M36 |
| 924 | 914 | | 39 | +3/0 | 1010 | 150 | 960 | M36 |
| 1026 | 1016 | | 39 | +3/0 | 1105 | 150 | 1062 | M36 |

U-rørbøjle 1881 syrefast

Pipe clamp U-shaped type 1881 acid resistant



■ ■ U-rørbøjle type 1881, syrefast AISI 316. Rundjern med rullet gevind.

■ ■ U-shaped pipe clamp type 1881 acid resistant. Round bars with rolled thread.

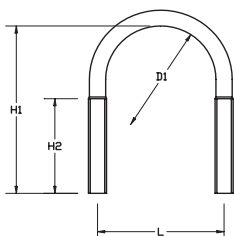

| D1 mm | For rør med udvendig dia. på: / For pipes with external dia. of: mm | Tommer / Inches | Hul for bøjle / Hole for clamp mm | TOL mm | H ₁ mm | H ₂ mm | L mm | D ₂ mm |
|-------|--|--------------------|--------------------------------------|--------|-------------------|-------------------|------|-------------------|
| 23 | 20/21,3/22 | ½" | 7 | +1/0 | 50 | 35 | 29 | M6 |
| 28 | 25/26,9 | ¾" | 7 | +1/0 | 55 | 35 | 34 | M6 |
| 36 | 33,7/35 | 1" | 9 | +1/0 | 65 | 40 | 44 | M8 |
| 44 | 42/42,4 | 1 ¼" | 9 | +1/0 | 75 | 40 | 52 | M8 |
| 50 | 48,3 | 1 ½" | 9 | +1/0 | 80 | 40 | 58 | M8 |
| 62 | 60,3 | 2" | 11 | +1/0 | 95 | 55 | 72 | M10 |
| 78 | 76,1 | 2 ½" | 11 | +1/0 | 110 | 60 | 88 | M10 |
| 91 | 88,9 | 3" | 11 | +1/0 | 125 | 60 | 101 | M10 |
| 117 | 114,3 | 4" | 11 | +1/0 | 155 | 75 | 127 | M10 |
| 146 | 139,7 | 5" | 11 | +1/0 | 175 | 75 | 156 | M10 |
| 174 | 168,3 | 6" | 11 | +1/0 | 215 | 75 | 184 | M10 |
| 225 | 219,1 | 8" | 11 | +1/0 | 270 | 90 | 235 | M10 |
| 278 | 273 | 10" | 11 | +1/0 | 325 | 90 | 288 | M10 |
| 330 | 323,9 | 12" | 11 | +1/0 | 330 | 385 | 100 | M10 |