

# Roller-Bearing Swivel, SKLI/SKLU

Electrically insulated, lubricated, sealed roller bearing swivel. Fully rotational even at maximum load. Tested to resist 1.000 V. Suitable for protection of overhead cranes during welding operations on suspended loads.

The Gunnebo Industries SKLI is equipped with a heavy duty roller bearing, enabling high durability and safe use also under severe load. It also has heavy duty nylon insulation inside to decrease friction when in use. The SKLI is compatible with the entire Gunnebo Industries SK-range for versatile use.

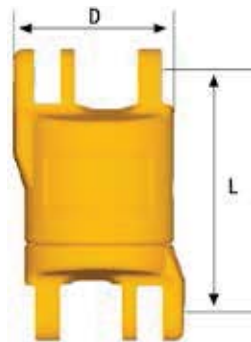

## Roller-bearing Swivel SKLI/SKLU

Art. no.	Code	WLL tonnes*	For chain dim.	L	D	Weight kgs
Z100316	SKLI-7/8-8	2.0	7,8	75	48	0.7
Z100414	SKLI-10-8	3.2	10	97	59	1.3
Z100415	SKLI-13-8	5.4	13	120	75	2.8
Z100416	SKLI-16-8	8.0	16	137	90	4.6
Z100417	SKLI-18/20-8	12.8	19	159	104	7.3
RS16520	SKLU-22-8*	15.5	22	160	109	9.2
RS16530	SKLU-26-8*	21.7	26	207	135	18.3

Fulfills requirements in: EN 1677:2008, ISO 8539:2009, ASTM A952/A952M, AS 3776:2015 and SANS 1595:2003.

\* Uninsulated

## Load Pin and Locking Collar - SKA

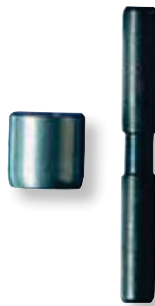

Art. no.	Code	Weight kgs
Z700674	SKA-6-8	0.01
Z323624	SKA-7/8-8	0.02
Z318024	SKA-10-8	0.04
Z303822	SKA-13-8	0.08
Z303725	SKA-16-8	0.14
Z145048	SKA-18/20-8	0.26
Z133530	SKA-22-8	0.35
Z605407	SKA-26-8	0.63
Z650554	SKA-32-8	1.05

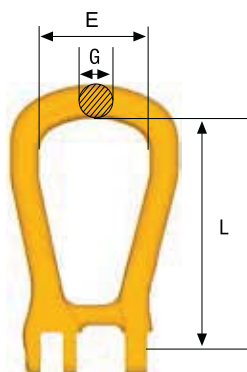

## Master Link SKG (closed)

Art. no.	Code	WLL tonnes*	For chain dim.	L	E	G	Weight kgs
Z419684	SKG-7/8-8	2.0	7,8	99	50	14	0.3
Z419781	SKG-10-8	3.2	10	127	66	18	0.6
Z419888	SKG-13-8	5.4	13	145	72	22	1.1
Z419985	SKG-16-8	8.2	16	175	82	25	1.5
Z420086	SKG-18/20-8	12.8	19	204	105	30	3.0

Fulfills requirements in: EN 1677:2008, ISO 8539:2009, ASTM A952/A952M, AS 3776:2015 and SANS 1595:2003.